

Metal Desk Fans

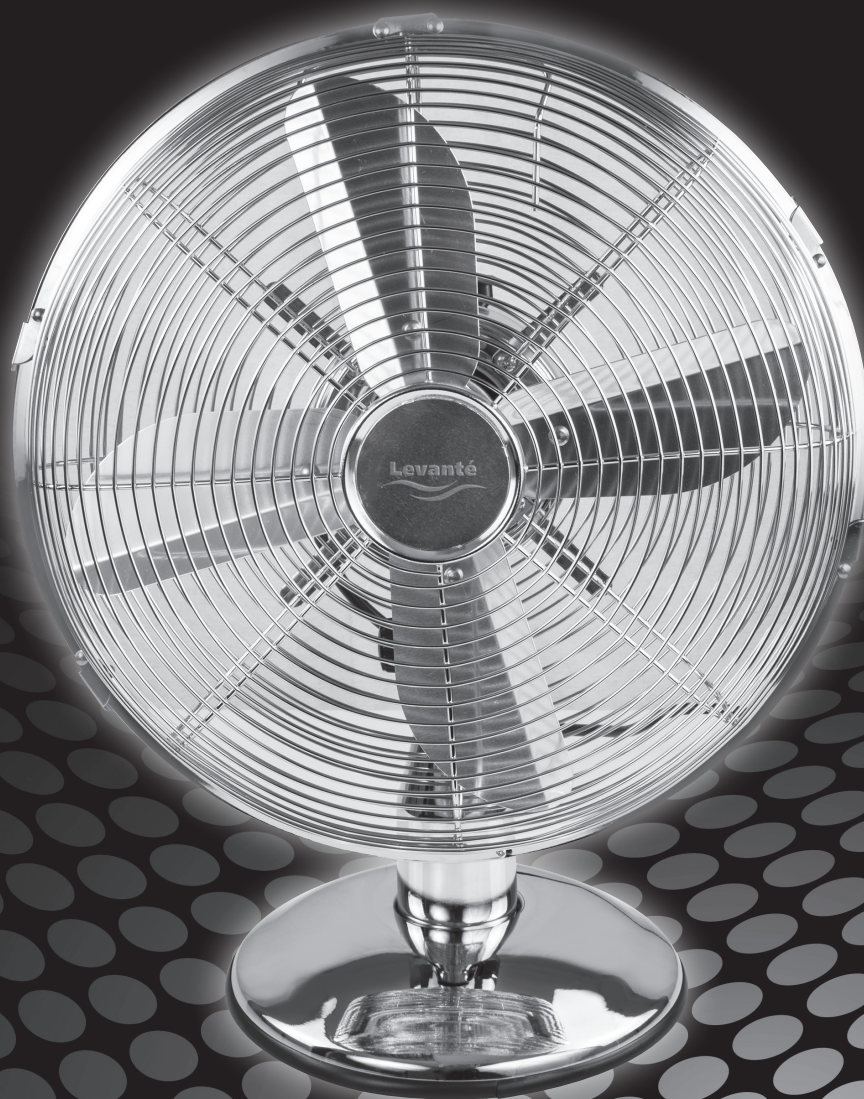

Operation Manual

Note: These instructions must be read fully before commencing use of the heater.

Please retain these instructions for future reference.

FOR INDOOR USE ONLY

Models: LEV9MDF and LEV12MDF

INTRODUCTION

This sleek & modern high-velocity fan provides more powerful wind than ordinary plastic fans. Draws air off the floor and circulate through the entire room keeping room cool and breezy. Put near the windows and it helps exhaust hot indoor stuffy air and pulls in fresh outdoor air.

- Energy-saving, high velocity motor for maximum air circulation
- Tilt-adjustment for flexible use
- Triple speed selection
- Precision fan blades for powerful wind with low-noise
- Chrome-stand, solid construction with thermal-protection to prevent motor overheat.

IMPORTANT SAFEGUARDS

Before use, please read and follow these instructions carefully, even if you feel you are familiar with the product. They contain important information concerning the operation, safety and maintenance when using the product.

Please retain these instructions for future use and reference.

- Do not use the fan if the power cable is damaged.
- Never insert fingers, pencils or any other objects into the grid when the fan is running.
- Unplug the fan from the power socket when moving it from one location to another.
- Unplug the fan from the power socket when removing grids for cleaning.
- Ensure fan is standing on a stable surface before operating.
- Do not place the fan close to an open window. Rain splashing onto the fan could cause an electric shock hazard.
- Completely assemble the fan before switching the fan on.

Model covered by this instruction guide:

LEV9MDF - 30W Metal Pedestal Fan

LEV12MDF - 35W Metal Pedestal Fan

Warning

Do not cover the fan.



INSTALLATION GUIDE

ASSEMBLY OF BLADE AND GRILL

KEY:

1. Front safety grill
2. Fan blade
3. Fan blade lock screw
4. Handle
5. Motor spindle
6. Speed dial
7. Rotation regulator
8. Motor
9. Tilt adjustment screw
10. Body
11. Rear safety grill
12. Screws
13. Fastening clip

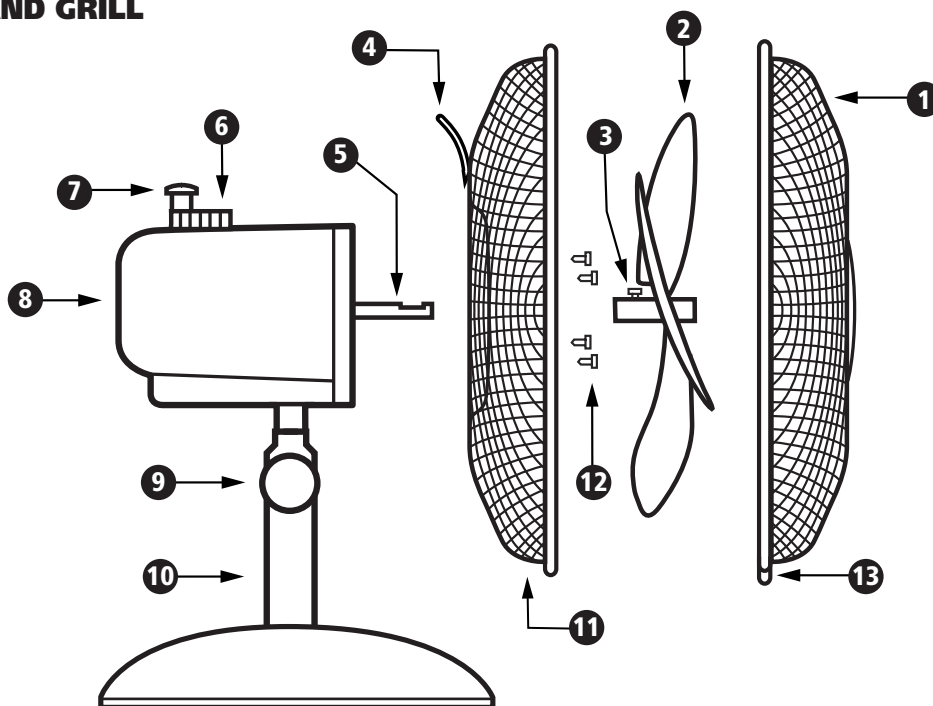

Speed dial and rotation regulator

ASSEMBLY

1. Put the rear grill onto the front of the motor and fix with the 4 screws provided, making sure the handle is at the top.
2. Remove and discard safely the PVC sleeve on the motor spindle.
3. Push the fan blade onto the motor spindle and tighten the fan blade lock screw.
4. Mount the front safety grill onto the rear safety grill by hanging the hook on the front grill over the top of the rear grill and close the clasps all around the grill. The fan is now ready to operate, please see operating instructions below.

OPERATING INSTRUCTIONS

1. Plug the power cord into a suitable socket, making sure the fan is switched off (0).
2. To activate or deactivate oscillating action, push in/pull out the rotation regulator on the top of the motor housing.
3. The up and down angle of the airflow is adjusted as follows:
 - Tilt the head up or down to the required position by untightening the tilt adjustment screw (9).
 - The tilt adjustment screw when re-tightened will hold the fan in the desired position.
4. Switch on the fan to the desired setting, using the 4 position knob on the top of the motor housing and the speed selected as follows:

0 = OFF

I = LOW SPEED

II = MEDIUM SPEED

III = HIGH SPEED

9" 2.6m/s

3.2m/s

3.8m/s

12" 2.9m/s

3.5m/s

4.0m/s

LIMITED WARRANTY

This product has been made under strictest quality control procedures to ensure good performance and reliability. This product has a warranty against defects in materials and workmanship for 12 months from the date of purchase.

PROVIDED:

1. Reasonable evidence is supplied to prove the product has been purchased within 12 months prior to the date of claim.
2. The defect is not due to misuse, neglect, accidental damage or repair by unqualified engineers.

This warranty does not cover any claims for consequential loss or damage.

These statements do not affect your statutory rights as a customer.

CARE AND CLEANING

Ensure that the fan is unplugged from the mains and is cool before you attempt to clean it. Wipe with a dry cloth to remove dust or with a damp (not wet) cloth to clean stains. Ensure that no moisture gets into the motor.

Do not use abrasive cleaning powder, metal polish or furniture polish on any part of the fan.

CUSTOMER SERVICE

Repairs must be carried out by authorised specialists, thus ensuring electrical safety. Please contact a service agent or a suitably qualified electrician. Improper repairs could lead to danger to the user.

The warranty does not cover damage of failure which results from alteration, accident, misuse, abuse, neglect, commercial use or improper maintenance.

In line with our policy of continuous product development we reserve the right to change the product and documentation specifications without notice.

DISPOSAL

In accordance with European Directive 2002/96/EG concerning waste electrical and electronic equipment (WEEE), please return any electrical equipment that you will no longer use to the collection points provided for their disposal.



This symbol indicates that the appliance cannot be treated as normal domestic waste, but must be handed to a collection point for where electric and electronic appliances are recycled.

Information concerning where the equipment can be disposed of can be obtained from your local authority.

EN 60335-1:2012

1. This appliance can be used by children aged from 8 years and above and persons with reduced physical, sensory or mental capabilities or lack of experience and knowledge if they have been given supervision or instruction concerning use of the appliance in a safe way and understand the hazards involved.
2. Children shall not play with the appliance.
3. Cleaning and user maintenance shall not be made by children without supervision.

EN 60335-2-30:2009+A11

1. Children of less than 3 years should be kept away unless continuously supervised. Children aged from 3 years and less than 8 years shall only switch on/off the appliance provided that it has been placed or installed in its intended normal operating position and they have been given supervision or instruction concerning use of the appliance in a safe way and understand the hazards involved. Children aged from 3 years and less than 8 years shall not plug in, regulate and clean the appliance or perform user maintenance.
2. Some parts of this product can become very hot and cause burns. Particular attention has to be given where children and vulnerable people are present.