

RING COVER FOR REFUSE BOX

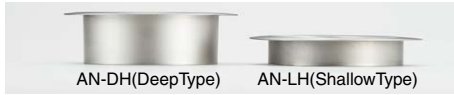

AN-DH, AN-LH



Installation



Flange

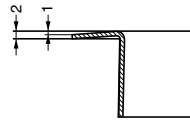

Cut Out Dimensions

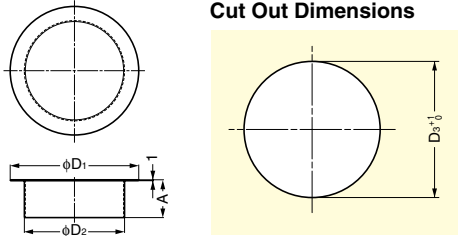

Item Code	Item Name	Material	Finish	Weight	Box	Carton
210-032-779	AN-DH005-GP	Stainless Steel (SUS304)	Gold	66 g	1 pc	50 pcs
210-032-780	AN-DH005-MR	Stainless Steel (SUS304)	Mirror	66 g	1 pc	100 pcs
210-032-781	AN-DH005-HL	Stainless Steel (SUS304)	Satin	66 g	1 pc	100 pcs
210-022-094	AN-DH008-GP	Stainless Steel (SUS304)	Gold+Clear	107 g	1 pc	10 pcs
210-022-095	AN-DH008-MR	Stainless Steel (SUS304)	Mirror	107 g	1 pc	10 pcs
210-022-096	AN-DH008-HL	Stainless Steel (SUS304)	Satin	107 g	1 pc	10 pcs
210-170-078	AN-DH011-GP	Stainless Steel (SUS304)	Gold+Clear	137 g	1 pc	10 pcs
210-170-076	AN-DH011-MR	Stainless Steel (SUS304)	Mirror	137 g	1 pc	10 pcs
210-170-077	AN-DH011-HL	Stainless Steel (SUS304)	Satin	137 g	1 pc	10 pcs
210-172-533	AN-DH015-GP	Stainless Steel (SUS304)	Gold+Clear	182 g	1 pc	10 pcs
210-172-532	AN-DH015-MR	Stainless Steel (SUS304)	Mirror	182 g	1 pc	10 pcs
210-172-531	AN-DH015-HL	Stainless Steel (SUS304)	Satin	182 g	1 pc	10 pcs
210-044-812	AN-DH020-HL	Stainless Steel (SUS304)	Satin	230 g	1 pc	6 pcs
210-044-813	AN-DH028-HL	Stainless Steel (SUS304)	Satin	290 g	1 pc	4 pcs
210-032-782	AN-LH005-GP	Stainless Steel (SUS304)	Gold	50 g	1 pc	50 pcs
210-032-783	AN-LH005-MR	Stainless Steel (SUS304)	Mirror	50 g	1 pc	100 pcs
210-032-784	AN-LH005-HL	Stainless Steel (SUS304)	Satin	50 g	1 pc	100 pcs
210-022-097	AN-LH008-GP	Stainless Steel (SUS304)	Gold+Clear	77 g	1 pc	10 pcs
210-022-098	AN-LH008-MR	Stainless Steel (SUS304)	Mirror	77 g	1 pc	10 pcs
210-022-099	AN-LH008-HL	Stainless Steel (SUS304)	Satin	77 g	1 pc	10 pcs
210-022-100	AN-LH011-GP	Stainless Steel (SUS304)	Gold+Clear	92 g	1 pc	10 pcs
210-022-101	AN-LH011-MR	Stainless Steel (SUS304)	Mirror	92 g	1 pc	10 pcs
210-022-102	AN-LH011-HL	Stainless Steel (SUS304)	Satin	92 g	1 pc	10 pcs
210-022-103	AN-LH015-GP	Stainless Steel (SUS304)	Gold+Clear	122 g	1 pc	10 pcs
210-022-104	AN-LH015-MR	Stainless Steel (SUS304)	Mirror	122 g	1 pc	10 pcs
210-022-105	AN-LH015-HL	Stainless Steel (SUS304)	Satin	122 g	1 pc	10 pcs

Model	A	D ₁	D ₂	D ₃
AN-DH005	36	82	58	59
AN-DH008	36	112	82	83
AN-DH011	40	136	106	107
AN-DH015	36	170	146	147
AN-DH020	36	220	196	198
AN-DH028	36	300	276	278
AN-LH005	22	82	58	59
AN-LH008	22	112	82	83
AN-LH011	22	136	106	107
AN-LH015	22	170	146	147

MULTI-PURPOSE LID (W/DAMPER)



AD-KH



AD-KH015-HL



AD-KH020-HL



AD-KH028-HL

Features

- With damper to keep lid from slamming shut.
- New types are now available. (AD-KH020-HL and AD-KH028-HL)
- Made of stainless steel for corrosion resistance. Available in areas exposed to water.
- Wide opening.
- Balance weight restores lid to horizontal position.

Specifications

- Operating temperature: 0°C~40°C

Remarks

- Indoor use only.
- The closing speed varies depending on the operating temperature. For product stored below the freezing point, leave it indoor above 0°C for several hours before use.

Video Link



Installation

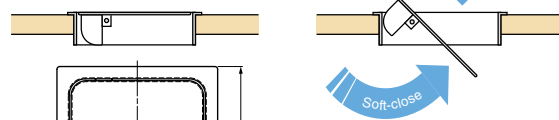

Cut Out Dimensions

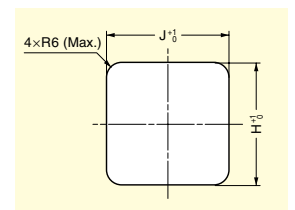

RoHS	CAD	Item Code	Item Name	Material	Finish	A	B	C	D	E	F	G	H	J	Weight	Box	Carton
✓	2020	210-022-108	AD-KH015-HL (Old:AD-KH017-HL)	Stainless Steel (SUS304)	Satin	170	170	1.2	36	146	80	93	147	147	970 g	1 pc	10 pcs
✓	—	210-037-893	AD-KH020-HL	Stainless Steel (SUS304)	Satin	220	220	1.2	50	196	77	127	197	197	1400 g	1 pc	6 pcs
✓	—	210-037-894	AD-KH028-HL	Stainless Steel (SUS304)	Satin	300	300	1.2	72	276	80	191	277	277	2700 g	1 pc	4 pcs



MISCELLANEOUS

RING COVER FOR REFUSE BOX / MULTI-PURPOSE LID (W/DAMPER)