



# KOALA KARE PRODUCTS

## Installation and Operation Instructions



## KB102

### Child Protection Seat (CPS)

Silla de protectora para niños

Siège de sécurité pour enfant (SSE)

Kinder-Sicherheitssitz (KS)

**IMPORTANT.** RETAIN FOR FUTURE REFERENCE. READ CAREFULLY.

**IMPORTANTE.** GUÁRDELO PARA FUTURAS CONSULTAS. LEER ATENTAMENTE.

**IMPORTANT.** À CONSERVER POUR INFORMATION. À LIRE ATTENTIVEMENT.

**WICHTIG.** ZUR SPÄTEREN BEZUGNAHME AUFBEWAHREN. BITTE SORGFÄLTIG DURCHLESEN.

You are responsible for the safe operation of this unit.



## KB102 Operating Instructions

**Please Note:** To assure proper installation, it is suggested that a qualified person or carpenter install the Koala Child Protection Seat. Koala Kare Products will not be responsible if the seat is not installed properly.

**You are responsible for the safe operation of this unit. Not intended to hold more than 50 lbs (22.7 kg).**

**Restraint System:** When a child is in the seat, the strap runs from the seat bottom, between child's legs, up to the waist where it fastens to the shoulder straps. Shoulder straps extend snugly over the shoulders and between the legs fastening at the waist. When the seat is open and child is in place, straps should hold child securely.

### Inspection Criteria:

- A properly maintained unit:
- Opens and closes smoothly
- Has two end caps located on lower sides of unit.
- Has fastening nut located at end of rod.
- Has both ends of a functioning, non-frayed strap, buckle clicks when closed and strap is attached at both ends of the unit.

### Tools Needed



gloves



drill



pencil

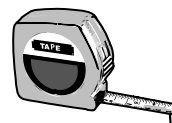

measuring  
tape

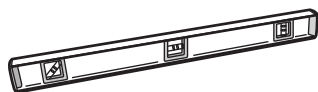

level



3/8" (9 mm)  
drill bit

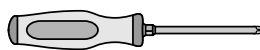

Phillips head  
screwdriver



Allen wrench

### Hardware Provided

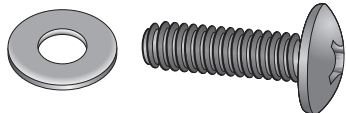

four 1/4" bolts and washers

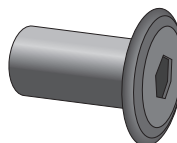

four threaded  
barrel bolts



## KB102 Installation Instructions

### Step 1.

The Child Protection Seat (CPS) is designed to be mounted on a bathroom or fitting room partition. The unit can also be mounted on a side wall (hardware not included). Establish proper CPS placement, taking door swing and clearance into consideration.

### Step 2.

Place the bottom of the unit 2" (51 mm) above the bottom of the partition or 14" (356 mm) above the floor, whichever is higher. Use the CPS as a template for locating and marking the mounting holes.

### Step 3.

After establishing the proper placement of the four mounting holes, drill through the partition using a 3/8" (10 mm) drill bit.

### Step 4.

Insert the four threaded barrel bolts (supplied) from the outside of the partition. Mount the unit using the four 1/4" (6 mm) bolts and washers.

### Step 5.

Position Koala sign (supplied) on the outside of the restroom door. Replacement parts can be purchased from your local distributor or by calling toll free 888.733.3456 or 303.539.8300 in the U.S.

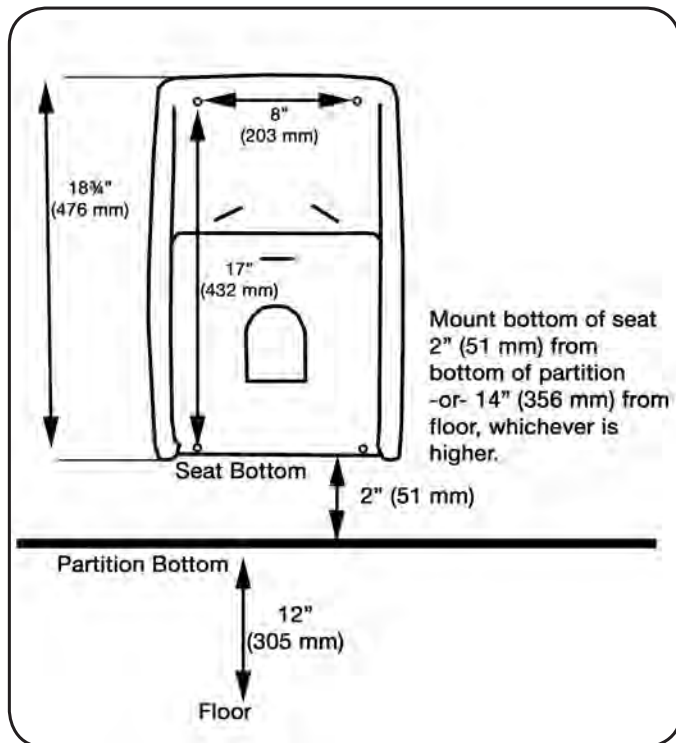

Insert Barrel Bolts from outside of partition wall. Use supplied hardware shown.

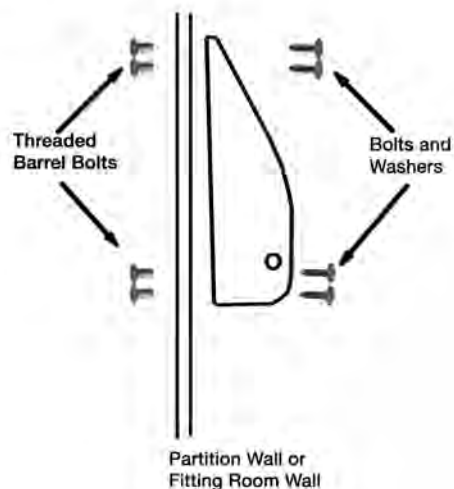

Unit Dimensions:  
Height: 18 3/4" (476 mm)  
Width: 12 1/4" (311 mm)  
Depth: 5 5/8" (143 mm) closed  
Depth: 12 1/4" (311 mm) open

