

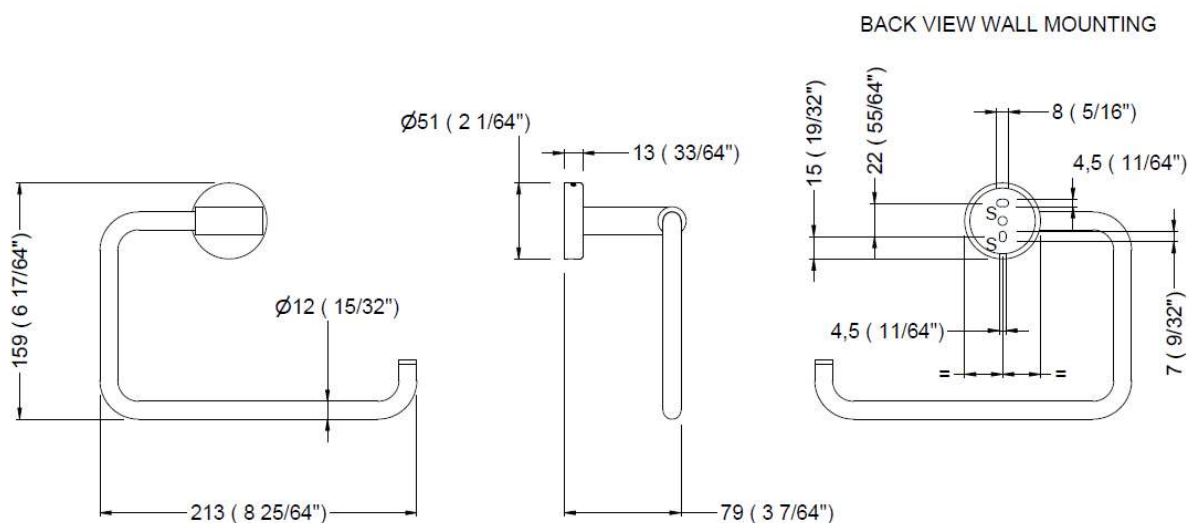

GW05 78 04 03

Open towel ring "NIMBUS series"



Dimensions: $\pm 3\%$

TECHNICAL DATASHEET

COMPONENTS AND MATERIALS

- Concealed wall plate – AISI 304 stainless steel. Secured to wall with two screws.
- Main body – AISI 304 stainless steel, matt black powder coat (RAL 9004). Secured to wall plate with one Allen stainless steel screw. The product incorporates the open ring for towels and the rear round anchor cover for installation.
- Fixings set - Two $\varnothing 6$ mm wall plugs, two $\varnothing 4$ mm screws and one Allen key.

OPERATION

Suitable for hotel or residential bathrooms. No specific operation instructions.

MOUNTING

Loosen main body bottom setscrew so wall plate can be removed. Drill two $\varnothing 6$ mm holes to suit provided wall plugs (6mm) and screws (4mm) at S points indicated in technical design. Secure wall plate to the wall. Place main body and tighten setscrew at the bottom so to secure with wall plate.

ARCHITECTURAL SPECIFICATION

Genwec open towel ring "Nimbus series" shall be made of AISI 304 stainless steel. Shall be RAL 9004 matt black powder coated.

The product incorporates the open ring for towels and the rear round anchor cover for installation.

Edges should be smooth for user safety.

SPARE PARTS

GW05 78 90 00 – Fixings set